

DRAINAGE PLAN
SCALE - 1 : 100

Internal House Drainage sanctioned plan
(vide no. INT/2024100074 dated 19.09.24)

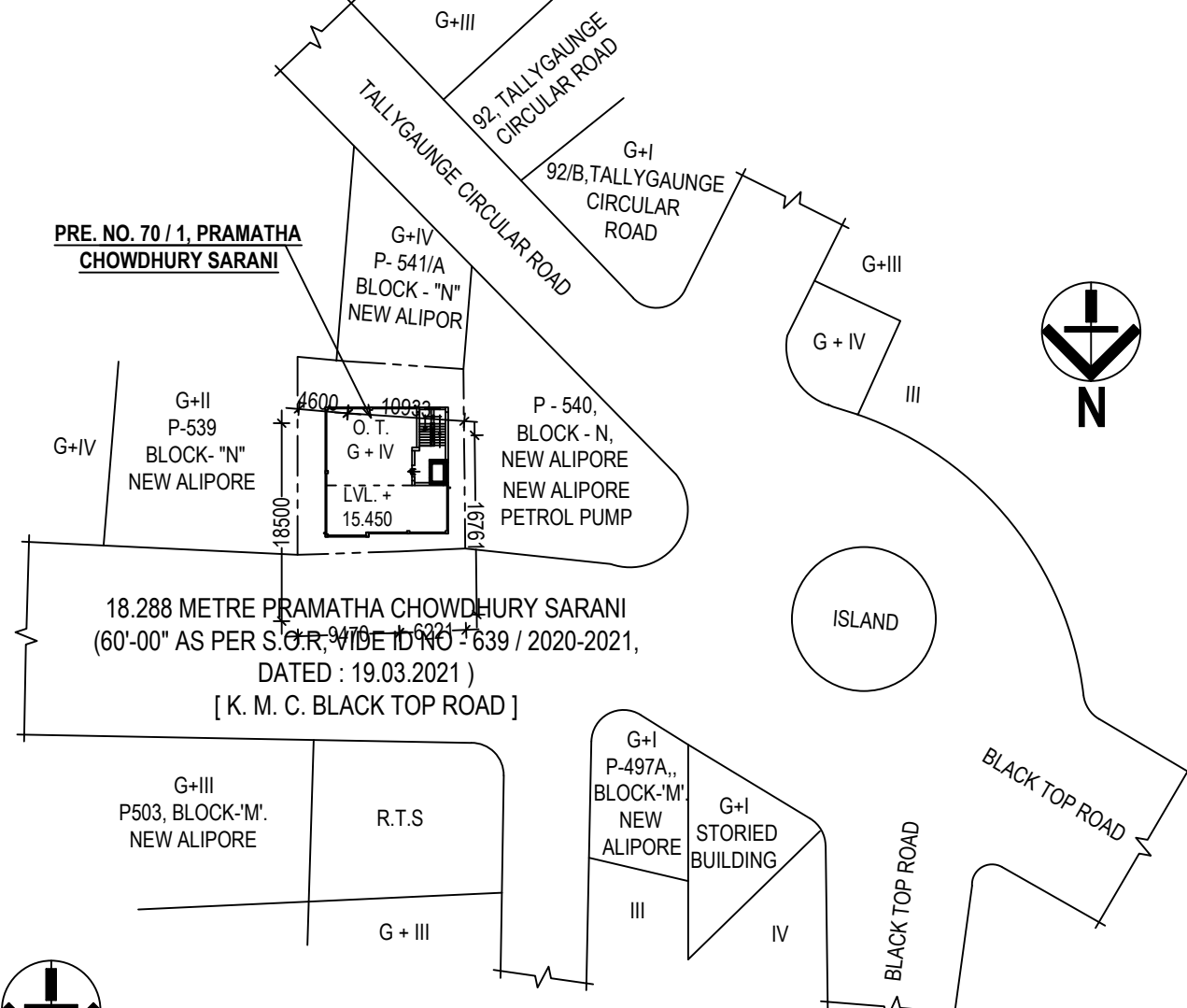

SITE PLAN
SCALE - 1 : 600

FLOOR MARKED	KITCHEN	TOILET	W.C.
GR.	NIL	01 NO.	NIL
1ST.	NIL	01 NO.	NIL
2ND.	01 NO.	01 NO.	NIL
3RD.	01 NO.	02 NOS.	01 NO.
4TH.	01 NO.	01 NO.	NIL



INTERNAL HOUSE DRAINAGE PLAN OF GROUND + FOUR STORIED RESIDENTIAL BUILDING AT PREMISES NO. 70 / 1, PRAMATHA CHOWDHURY SARANI, P.S. NEW ALIPORE , KOLKATA 700 053, WARD NO. 81, BOROUGH X [K.M.C.]

N. Jagwani
SRI NIRMAL JAGWANI & SRI LOKESH KUMAR PANJWANI,
DEVELOPER OF M/S JKL VIRAAT DEVELOPER LLP,
CONSTITUTE ATTORNEY OF
(I) TANIA GHOSE, (II) RIMA GHOSE

SIGNATURE OF OWNER / AUTHORITY
SRI NIRMAL JAGWANI & SRI LOKESH KUMAR PANJWANI,
DEVELOPER OF M/S JKL VIRAAT DEVELOPER LLP,
CONSTITUTE ATTORNEY OF
(I) TANIA GHOSE, (II) RIMA GHOSE

Anupam Ghosh
ANURAM GHOSH
Registered Architect
Reg. No. - CA/2005/36555

SIGNATURE OF ARCHITECT
Mr. ANUPAM GHOSH
Registered Architect
Reg. No. CA / 2005 / 36555.

BARUN DUTTA (PLUMBER)
P.L. NO. 1098
DATE 19.11.2021
Barun Dutta
BARUN DUTTA (PLUMBER)
P.L. NO. 1098
DATE 19.11.2021
Barun Dutta

SIGNATURE OF PLUMBER
Mr. BARUN DUTTA (PLUMBER)
P.L. NO 1098, DATE : 19.11.2021

SIGNATURE OF ASSISTANT ENGINEER(C)
BOROUGH - X, K.M.C

SIGNATURE OF EXECUTIVE ENGINEER(C)
BOROUGH - X, K.M.C